

WEISER

aura

BLUETOOTH KEYPAD SMART LOCK



How to Perform the Door Handing Process:

1

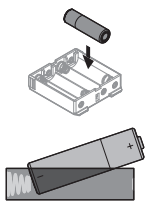

Install 4 AA batteries in battery pack.

2

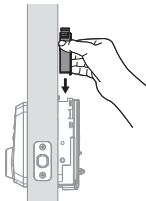

With the door open, install the battery pack to initiate auto-handing.

3

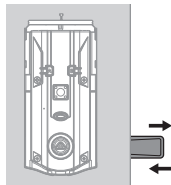

The latch will retract and extend to learn the orientation of the door. If the bolt does not move, make sure the batteries are correctly installed, the interior assembly is correctly installed onto the mounting plate.

Note: The latch bolt will only retract half way.

4

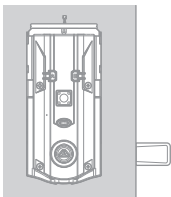

The Status LED will indicate success or failure.

Green: Door handing was successful. Proceed to next step.

Red: Door handing was unsuccessful. Make sure the lock interior and batteries are correctly installed. Perform step 4B again.

If the door handing process is still unsuccessful after a second attempt, repeat this process again.

THE LEADER IN RESIDENTIAL SECURITY

213826 10/17

WEISER

aura

BLUETOOTH KEYPAD SMART LOCK



How to Add or Remove a Code:

The Weiser app is needed to use this lock. If this lock was professionally installed (or installed by someone other than the homeowner), make sure this step is performed by the homeowner.

1



Download the Weiser app by scanning the QR code or visiting www.weiserlock.com/app on your smartphone.

2



Weiser

Create your account and follow the setup instructions in the Weiser app.

3



Turn on Bluetooth to allow the Weiser app to connect to Aura and stay within Bluetooth range of the lock

4



Enter user code to test the lock. A total of 250 customizable user codes may be programmed.

THE LEADER IN RESIDENTIAL SECURITY

213826 10/17